



**KITCHEN AND
BATHROOM
SYSTEMS**





Vortice Limited is a part of a multinational group employing over 400 employees worldwide. Established in the UK since 1977, Vortice has over 100 years combined knowledge and service in combatting mould and condensation in the residential sector.



AER DMEV 100

DECENTRALISED
MECHANICAL EXTRACT
VENTILATION



FEATURES

- **Sleek & Attractive:** Modern, low-profile design to compliment any home
- **Ultra-Efficient:** Extremely low energy consumption and running costs
- **Whisper-Quiet:** Near-silent operation, preventing unwanted noise and encouraging continuous use
- **Unmatched Performance:** Consistently delivers exceptional results and tenant acceptability
- **Safe by Design:** Ideal for all bathroom zones including zone 1, ensuring your peace of mind and safety



AER DMEV 100



APPLICATION

- AER DMEV 100 is a decentralised, continuously running extract fan that is ideal for kitchens, bathrooms, en-suites, utility rooms and toilets. Designed to extract stale air directly to the outside or through a ducted system. It can be wall, ceiling or window mounted (using window mounted kit).

OPERATION

- The unit will run continuously at the speed selected by the engineer at the time of installation. If the fan senses a sudden rise in humidity, the automatic boost function will be activated to provide the required additional ventilation.
- Maximum speed can be achieved using the integral pull cord, remote switch or light switch. The fully adjustable run-on timer will activate if the maximum speed has been activated for a period of 3 minutes or more.

FEATURES/BENEFITS

- Aesthetically pleasing and modern front cover easily removed for cleaning and inspection.
- Multiple speeds and fully adjustable to allow easy and exact commissioning to meet desired ventilation rates.
- EC brushless motor to ensure extremely low power consumption.
- Constant flow function to guarantee desired performance and overcome resistance.
- Intelligent automatic humidity control that will only increase in response to rapid rise in humidity, preventing unnecessary heat loss, energy consumption and noise.
- Intelligent run-on timer which will only activate if the fan's boost function has been activated for a period of 3 minutes or more to prevent unnecessary energy consumption and noise.
- IPX4 rated.
- Environmentally friendly, all plastic components fully recyclable.
- Double insulated meaning no earth connection is required.



Looking for a supply and install service?

BOOK A SURVEY TODAY
www.vorticemouldsolutions.co.uk





PRODUCT RANGE AND CODES

PRODUCT	CODE
AER DMEV 100	10208
AER DMEV 100 SELV	10209

ACCESSORIES RANGE AND CODES

PRODUCT	CODE
WINDOW KIT AER DMEV 100	20686
GASKET KIT AER DMEV 100	20687

INSTALLATION

Unit can be fitted in either zone 1 or 2 of a bath/shower room. For maximum efficiency the fan should be sited at a high level, as close as possible to the source of moisture. The transformer should be positioned ideally on an internal wall 100-150mm from the top of the ceiling (refers only to SELV version).

CONSTRUCTION

- Casing made of high quality ABS being long lasting, shock-proof and robust construction. The unit is finished in white RAL 9010 and is UV resistant.
- Unique design winglet-type impeller, providing enhanced aerodynamic properties, low noise and increased efficiency.
- EC brushless motor with integral thermal protection, mounted on sealed-for-life high quality ball bearings to ensure a longer fan life and ideal also for cold climates.
- Stator with aerodynamic deflectors to reduce air turbulences and designed to maximise performance and efficiency.

TESTING AND CERTIFICATION

Units are tested to ensure accurate, up to date information on electrical safety, performance and noise level that can be relied upon. Designed and manufactured in accordance with EN60335-2-80 (Low Voltage Directive) and the EMC Directive (Electromagnetic Compatibility).



PERFORMANCE

PRODUCT	CODE	W min max	A min max	AIRFLOW l/s min max	Lp dB (A) 3m ⁽¹⁾ min max	°C max	WEIGHT KG
AER DMEV 100	10208	1.2 5.8	0.06	5 25	<9 38	40	0.6
AER DMEV 100 SELV	10209	1.2 5.8	0.06	5 25	<9 38	40	0.6

- 220-240V ~ 50/60Hz

- air performance measured according to ISO 5801 @ 230V ~ 50Hz, air density 1,2Kg/m³.

(1) sound pressure level @ 3m in free field, for comparative purposes only.

RESIDENTIAL VENTILATION
KITCHEN AND BATHROOM SYSTEMS

PERFORMANCE CURVE - THROUGH THE WALL

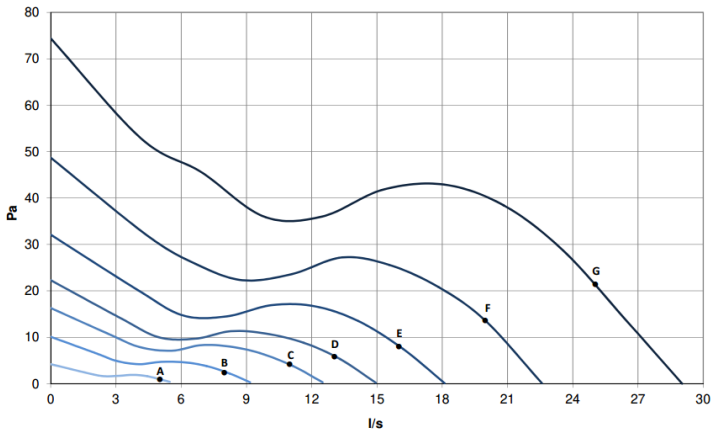

WORKING POINT	m ³ /h	SPI (W/m ² /h)	l/s	SPI (W/l/s)	W	dB(A) @3m
A	18	0,056	5	0,25	1,2	<9
B	29	0,042	8	0,18	1,4	12
C	40	0,040	11	0,16	1,7	16
D	47	0,041	13	0,16	2	21
E	58	0,043	16	0,15	2,3	29
F	72	0,050	20	0,18	3,4	36
G	90	0,064	25	0,23	5,8	38

PERFORMANCE CURVE - IN ROOM

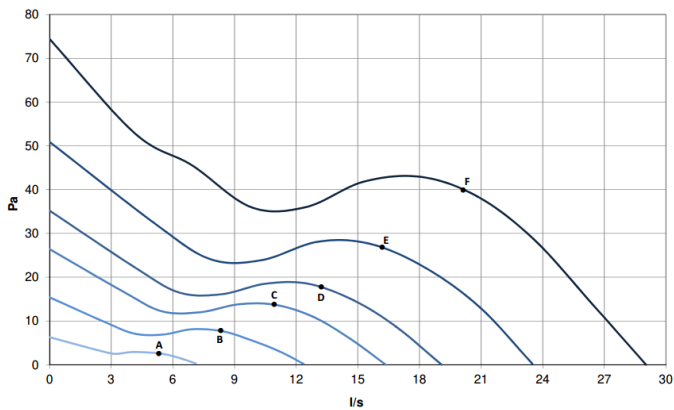

WORKING POINT	m ³ /h	SPI (W/m ² /h)	l/s	SPI (W/l/s)	W	dB(A) @3m
A	18	0,061	5	0,26	1,3	<9
B	29	0,052	8	0,21	1,7	17
C	40	0,053	11	0,19	2,1	24
D	47	0,053	13	0,19	2,5	29
E	58	0,062	16	0,22	3,4	34
F	72	0,078	20	0,28	5,6	38

DIMENSIONS

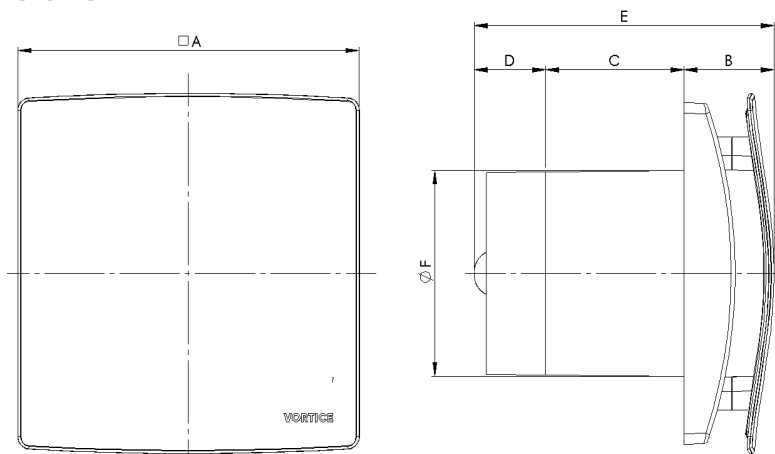

A	B	C	D	E	ØF	WEIGHT
173	47	70	36	152	99	0,6

Dimensions in mm

DIMENSIONS - GASKET

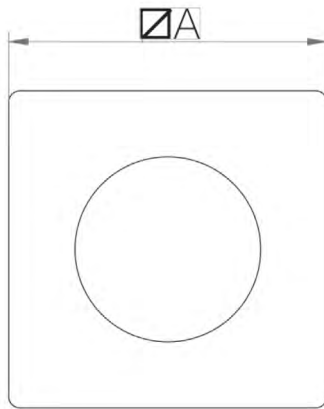
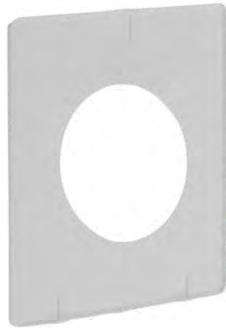

A	B
173	5

Dimensions in mm

DIMENSIONS - WINDOW KIT

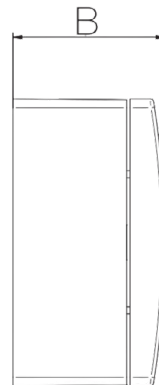
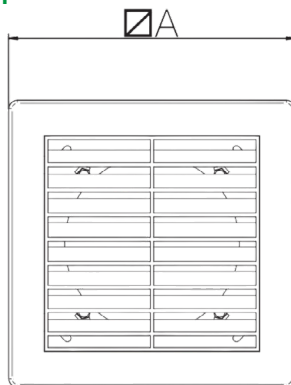

A	B	GLASS HOLE Ø
164	87	115

Dimensions in mm

BOOK A SURVEY TODAY !

www.vorticemouldsolutions.co.uk

VORTICE GROUP

VORTICE LIMITED

Beeches House
Eastern Avenue
Burton upon Trent
DE13 0BB United Kingdom
Tel. 01283 492949
socialhousing@vortice.ltd.uk
vorticemouldsolutions.co.uk

The descriptions and illustrations in this catalogue are intended to be indicative and not binding. Without prejudice to the essential characteristics of the products described and illustrated here, Vortice reserves the right to make, at any time and without notice, any changes to parts, aesthetic details or supply of accessories to its products that are deemed to be appropriate for improvement or for any construction or commercial requirement.
This printout completely cancels and replaces all previous ones.

